

Drop-Off and Pick-Up: 1st Grade

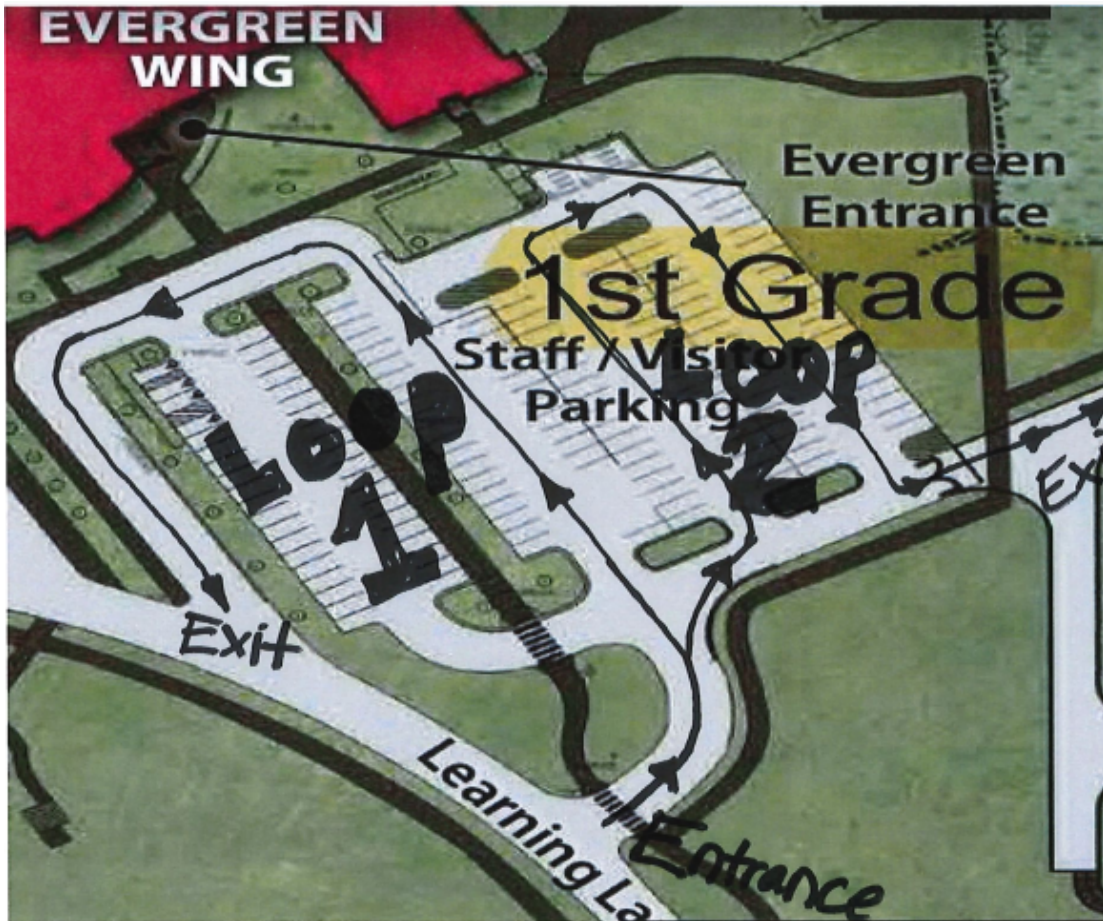

| | |
|--------|--|
| Loop 1 | Burk, Saagman, Heiks, Winkler, Sampson |
| Loop 2 | Beintema, Worthington, Francis, Choi |

- Please enter the parking lot from Learning Lane in order to keep traffic moving.
- Follow the loop of the teacher of the student you are dropping off/picking up and exit in the designated area.
- Students who are purchasing school breakfast may exit vehicles: when a staff member comes out with a "Breakfast" sign (approximately 8:20 am). Students will enter the building at the door where our staff member is standing.
- Students who are not eating school breakfast may exit vehicles: when a staff member comes out with a "Playground" sign (approximately 8:27 am). Students will go directly to the playground until the school bell rings.
- For student safety reasons, students must remain in their car until the staff member arrives with the breakfast sign or the playground sign.

**Student pick-up slips will be available at open House and will be handed out by staff at morning drop-off and dismissal during the first week of school.